

UNIVERSAL LEISURE CRADLE

Owner's Manual

REV02

This manual is the property of Ocean Safety Limited and its associated or subsidiary companies.

It must not be copied without prior written permission from Ocean Safety Limited or its associated or subsidiary companies.

All rights reserved.

**YOUR SAFETY
OUR WORLD**



1.0	INTRODUCTION	P3
1.1	Introduction	P3
1.2	Instruction video QR code	P3
1.3	Safety	P3
1.4	Strapping	P3
1.5	Size Guide	P4
2.0	PREPARATION	P5
2.1	Fixing pack	P5
2.2	Tools required	P6
2.3	Positioning the cradle	P6
3.0	CONSTRUCTION	P7
4.0	FITTING-DECK MOUNTED	P10
5.0	FITTING-RAIL MOUNTED	P12
6.0	STRAPPING	P14
7.0	MANUALLY RELEASING THE LIFERAFT	P16
8.0	CARE & MAINTENANCE	P17

1.0 INTRODUCTION

1.1 Thank you for purchasing this Ocean Safety product. Please follow the construction, mounting, usage and maintenance instructions to ensure the product is fitted safely and correctly. It is recommended that the cradle is built and the liferaft is fitted with at least two able-bodied people.

1.2 Please use the QR code below or go to bit.ly/ULCradle to reference the instruction video for construction and mounting the cradle. This is to be used alongside the user manual.



WARNING: PLEASE RETAIN THIS MANUAL FOR FUTURE REFERENCE



1.3 SAFETY

1. **ALWAYS** take care when using power tools, particularly if there is any water in the working area.
2. **ALWAYS** wear eye protection
3. **ALWAYS** check for pipes and cables before drilling into walls and floors.
4. **ALWAYS** use a drill that is suitable for the surface that is being drilled.
5. **DO NOT** use abrasive or chemical cleaners as these may damage the product.

1.4 Ocean Safety recommend the use of **Ocean Safety strapping and mounting brackets to secure the raft into the cradle, which are not included.** This cradle is recommended to be constructed on land before mounting to your vessel.

1.5 SIZE GUIDE

Type			Person						
Range	Pack	Mount	4	6	8	10	12	14	16
Ocean ISO	<24hr	Deck	●	●	●	●	●		
		Rail	●	●	●				
	>24hr	Deck	●	●	●	●	●		
		Rail	●						
	SOLAS B	Deck	●	●	●	●	●		
		Rail	●	●	●				

Container min and max size:

Min = L 450mm x W 400mm x H 230mm

Max = L 890mm x W 580mm x H 540mm

Max rail weight:

Rail mounting kits can only support up to 43kg.

2.0 PREPARATION

2.1 FIXING PACK



A. Left arm
(without grip) x1

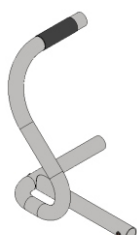

B. Left arm
(with grip) x1

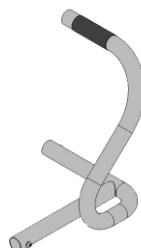

C. Right arm
(with grip) x1



D. Right arm
(without grip) x1



E. Width beam
(250mm) x4

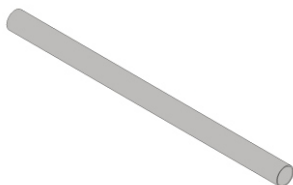

F. Length beam
(550mm) x2



G. Dome head screw
M5x5mmx12



H. Strapping assembly (Not included)



J. Short strap x1
(Not included)



K. Rail mounting
brackets x4 (Not included)



L. Rail mounting
bolts x16
(Not included)



M. Rail mounting
washers x16 (Not included)



N. Bow
Shackle
(Not included)



O. Rail mounting nuts
x16 (Not included)



P. Deck mounting
brackets x4
(Not included)



Q. Hydrostatic Hammar
Release Unit
(Not included)

2.2 EQUIPMENT REQUIRED

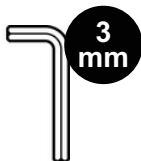

Thread Locker



2.3 POSITIONING THE CRADLE

2.3.1 The cradle can either be deck or rail mounted. For deck mounting, follow section 4.0, P9 and for rail mounting follow 5.0, P11.

2.3.2 Deck Mounted

This cradle is to be positioned on a flat clear area of deck. It is essential that there are no obstructions affecting the fitting or usage of the cradle.

If the cradle is fitted on top of an obstruction or affected by an obstruction. Ocean Safety will not be liable for any failure of the product or its operation.

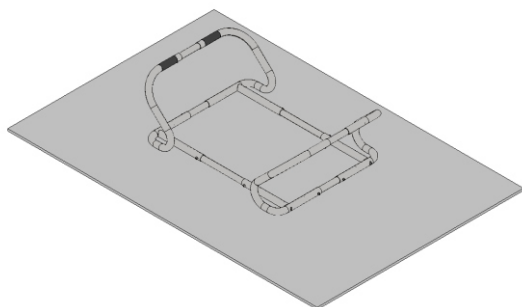

2.3.3 Rail Mounted

This cradle can be mounted on a rail, horizontally or vertically and can support a raft up to 43kg. Anything larger must be deck mounted. The cradle must only be mounted on structural stanchions or rails that can support the weight of a 43kg raft.

If the cradle is fitted on to an unsuitable rail or stanchions, Ocean Safety will not be liable for any failure of the product and its operation.

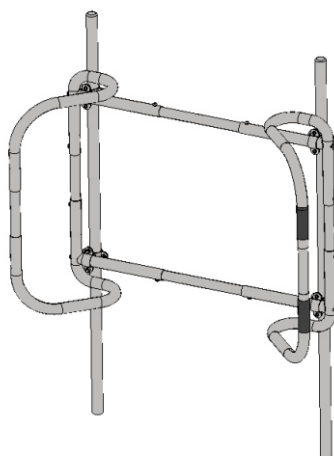

3.0 CONSTRUCTION

3.1 Feed the loop on the end of the straps onto a left and right arm with grip (B and C). Slide x2 width beam (E) into the left and right arm with grip (B and C). Ensure the beam with the strapping fed through is located at the bottom.

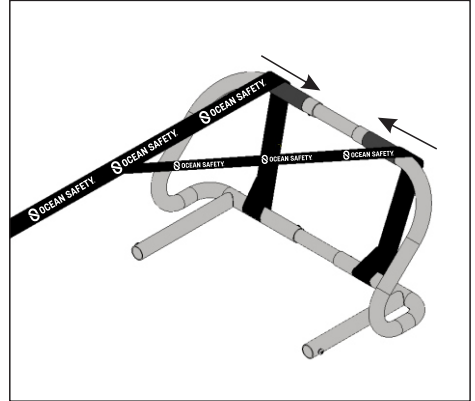
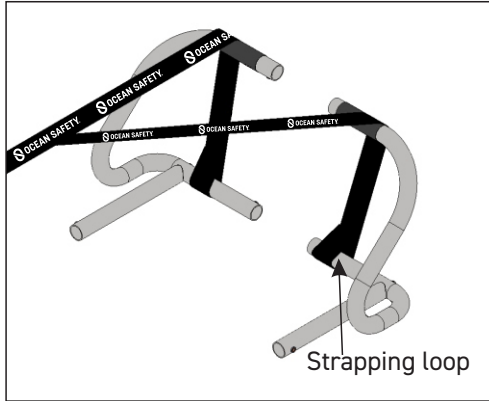

3.2 Repeat this process for the shortest strap (J) and left and right arm, without grip (A and D). Note: make sure the pelican hook is facing outwards as shown below.

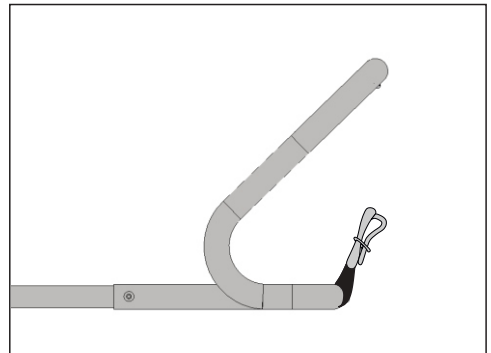
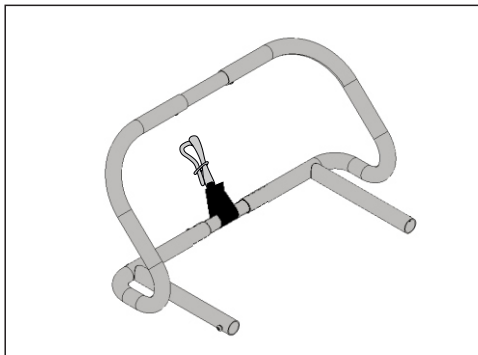

3.3 Slide the length beams (F) into the tubes on the arms, with grip (B and C).

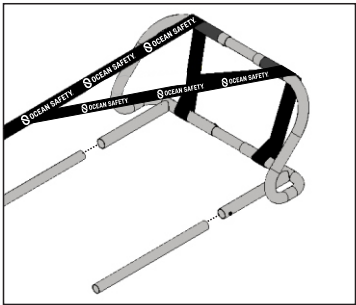

3.4 Slide the opposite arms without grip (A and D) into the other end of the length beams to join the cradle together. Ensure the length beams are evenly positioned between the arms before joining together.

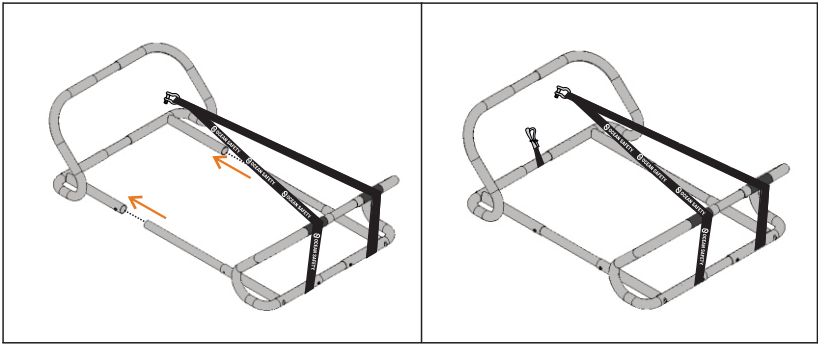

3.5 Position the liferaft in the cradle and slide the arms in or out accordingly to fit the desired liferaft.



WARNING: IT IS CRITICAL THAT THE CRADLE MAKES CONTACT WITH THE RAFT AS SHOWN BELOW



Straps hidden from illustration.

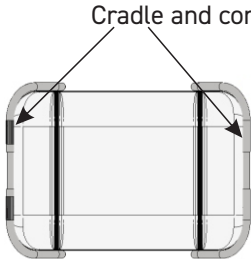

Top view (length).

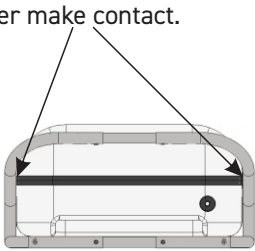

Side view (width).

3.0 CONSTRUCTION

3.6 Once the cradle has been adjusted to fit the desired container, carefully remove the container from the cradle without adjusting the set size.

3.7 Ensure the adjustable tubing width and length is central and covering the nuts. If the tubing is not evenly positioned it may not cover the nuts and cannot ensure secure positioning.

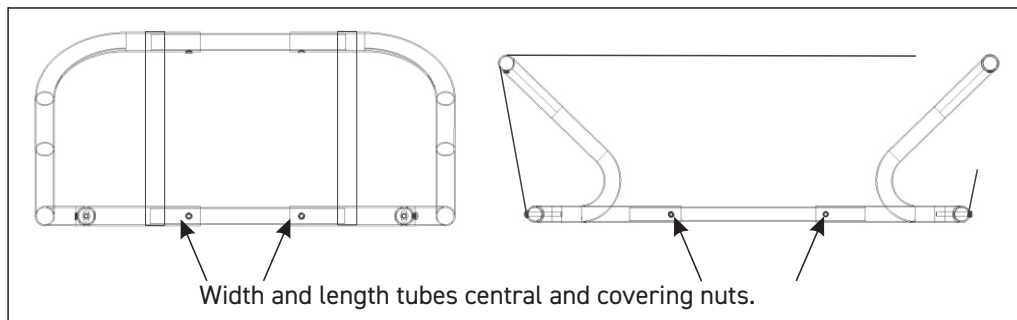

3.8 Once this is confirmed, screw the dome screws (G) into all twelve nuts and tighten securely with a 3mm allen key. The cradle can be fitted into the deck or rail.

3.9 Apply thread locker to thread of dome heads(G) and screw into nuts on the cradle to secure cradle in position.

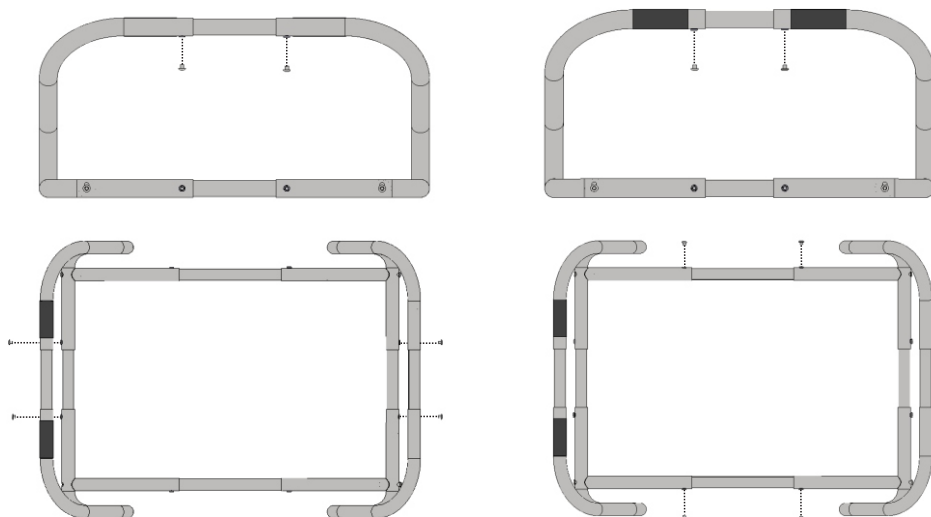

*Straps hidden from illustration.

4.0 FITTING-DECK MOUNTED



NOTE: DECK MOUNTED BRACKETS ARE SOLD SEPARATELY. FIXINGS FOR MOUNTING ARE NOT SUPPLIED. THEY WILL VARY ON THE DECK THE CRADLE IS FIXED TO. OCEAN SAFETY WILL NOT TAKE RESPONSIBILITY FOR ANY INCORRECT FIXING.



4.1 Position the structure onto the desired area of flat deck.

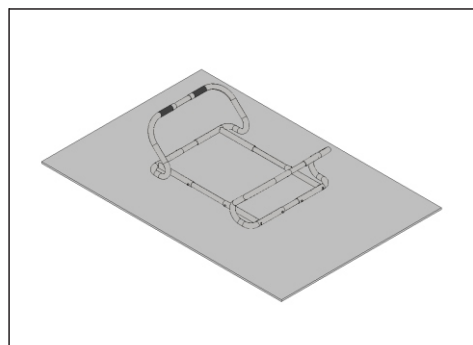

4.2 Place x4 mounting brackets (P) onto the cradle. Brackets to be fitted as close to the arms as possible.

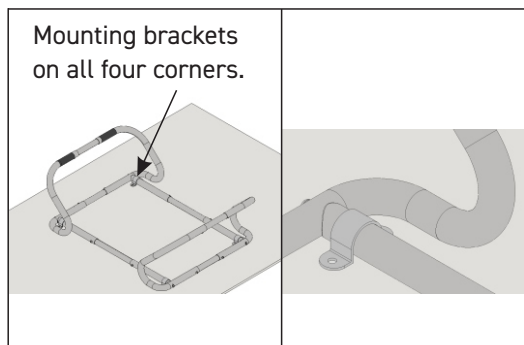

4.3 Mark x8 mounting bracket holes on the deck

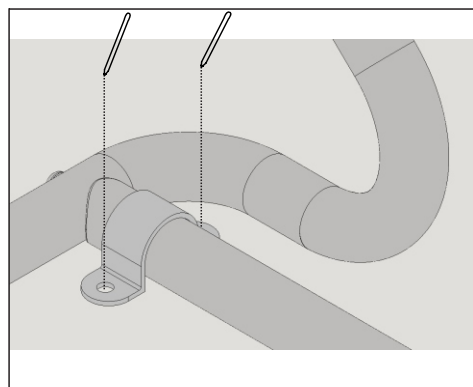

4.4 Remove the mounting brackets (P) and cradle from the deck. Drill x8 6mm holes in the marked locations.

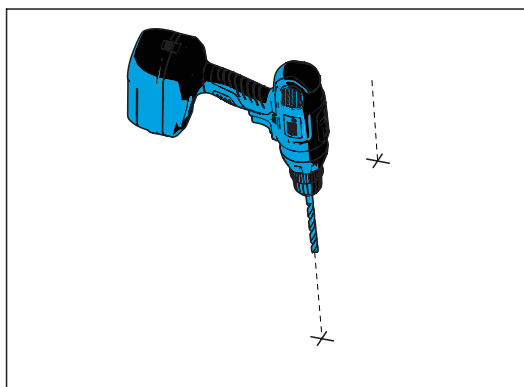

4.0 FITTING-DECK MOUNTED

4.5 Place the cradle and the mounting brackets (P) onto the drilled holes. Secure with the appropriate fixings for the deck that are through panel (not provided).

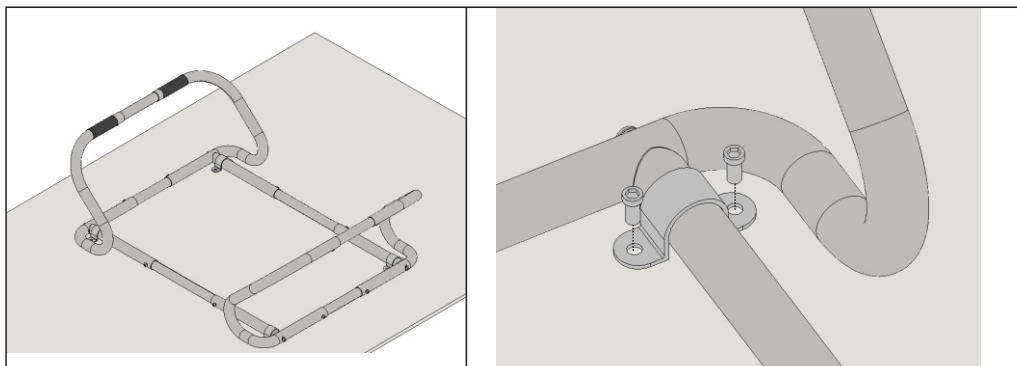

4.6 Once the cradle is secured to the vessel, position the liferaft inside. The side arms can be rotated up and down to provide room to lift the raft in and out. If this is not possible the mounting brackets (P) have been positioned in the wrong place and need re-positioning.

4.7 Push the arms out when placing the raft inside, then pull the arms back in to meet the raft once in position. Please continue to section 6.0 P13 for strapping instructions.

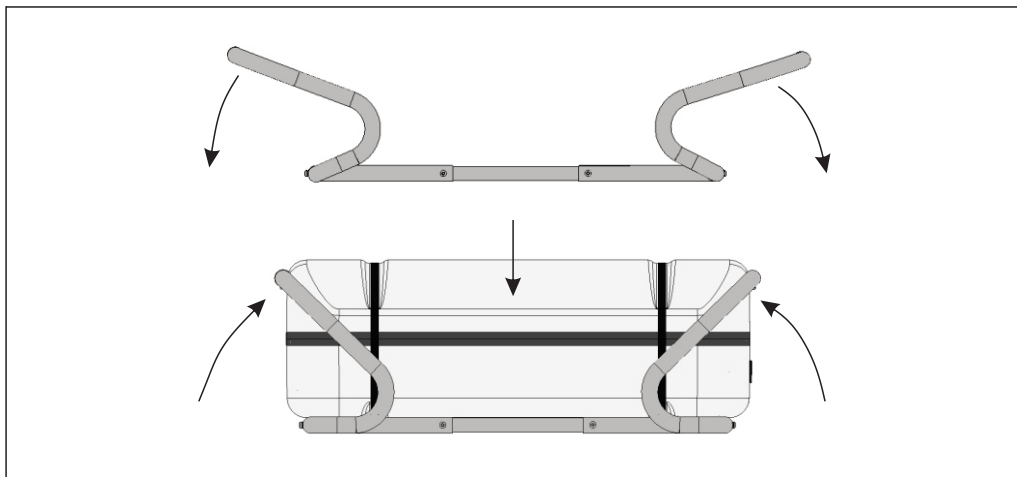

5.0 FITTING-RAIL MOUNTED



NOTE: RAIL MOUNTED BRACKETS ARE SOLD SEPARATELY. THE CRADLE IS DESIGNED TO SUPPORT UP TO A 43KG LIFERAFT ON A RAIL. IF THE LIFERAFT IS ANY HEAVIER, IT MUST BE DECK MOUNTED.



5.1 Position the cradle onto the desired area ensuring the bottom tubing overlaps two stanchions and there are no obstructions to deploy the liferaft. This can be horizontally or vertically mounted. Ensure the stanchion is strong enough to support the weight of the cradle and liferaft.

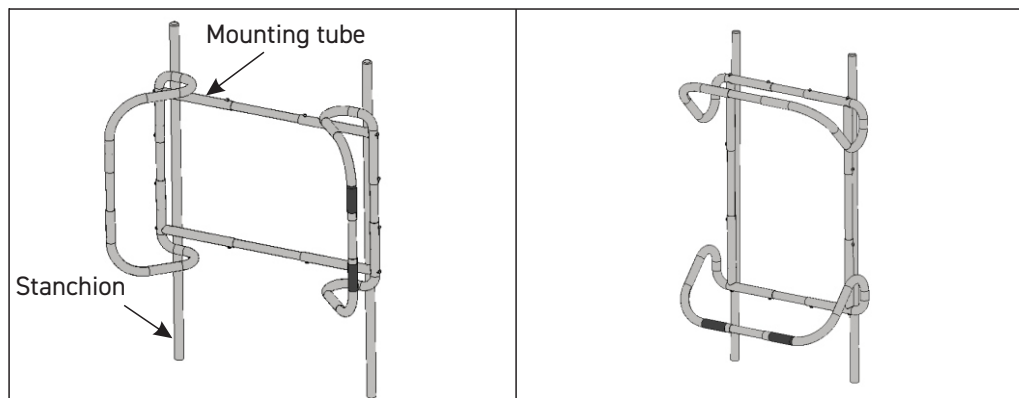

WARNING: DO NOT MOUNT THE CRADLE TO THE RAIL IN AREAS HIGHLIGHTED BELOW



5.2 Bolt x4 mounting brackets (K) onto the cradle using the mounting bolt (L) washer (M) and nuts (O). Tighten with a 5mm allen key. Position the brackets as close to the arms as possible.

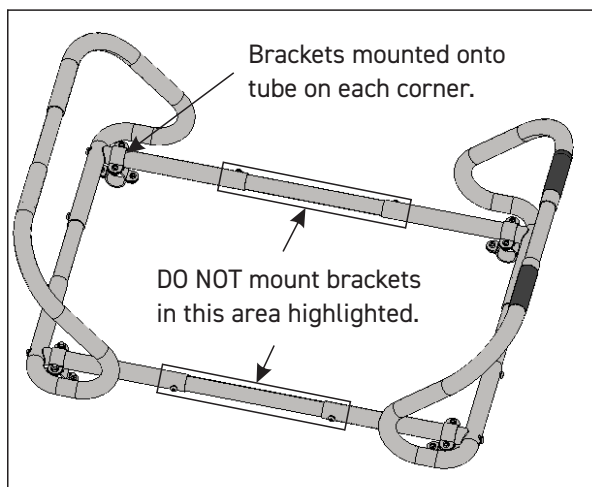

5.0 FITTING-RAIL MOUNTED

5.3 Bolt x4 mounting brackets (K) onto the stanchions using the mounting bolts (L) washer (M) and nuts (O). Use a spirit level to check the cradle is mounted at the same height on both stanchions. Tighten with a 5mm allen key. It is recommended that one person holds the cradle in position against the rail, while another mounts the brackets.



WARNING: IF VERTICALLY MOUNTED MAKE SURE THE GRIP ON THE CRADLE ARMS IS AT THE BOTTOM

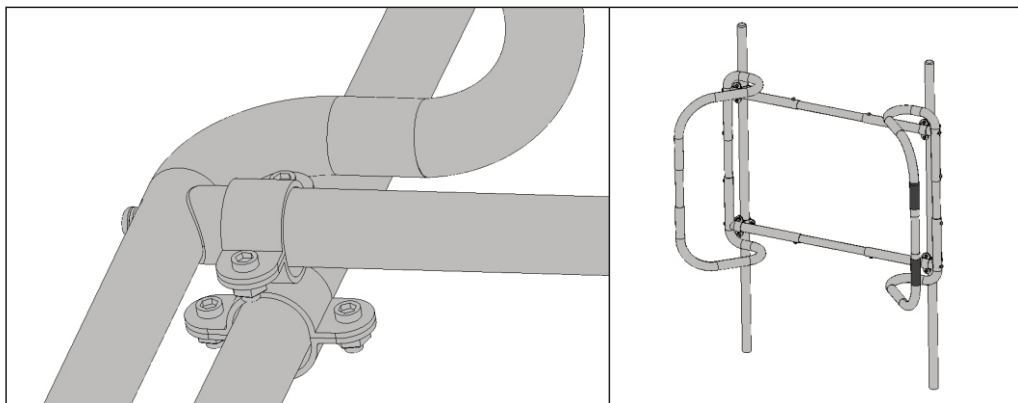

5.4 Once the cradle is secured to the vessel, position the liferaft inside. The arms can be rotated up and down to lift the raft in and out. If this is not possible, the mounting brackets have been positioned in the wrong place and need re-positioning. Push the arms out when placing the raft inside. If vertically mounted, ensure the painter line of the liferaft is at the top. Please continue to section 6.0 Strapping, P13.

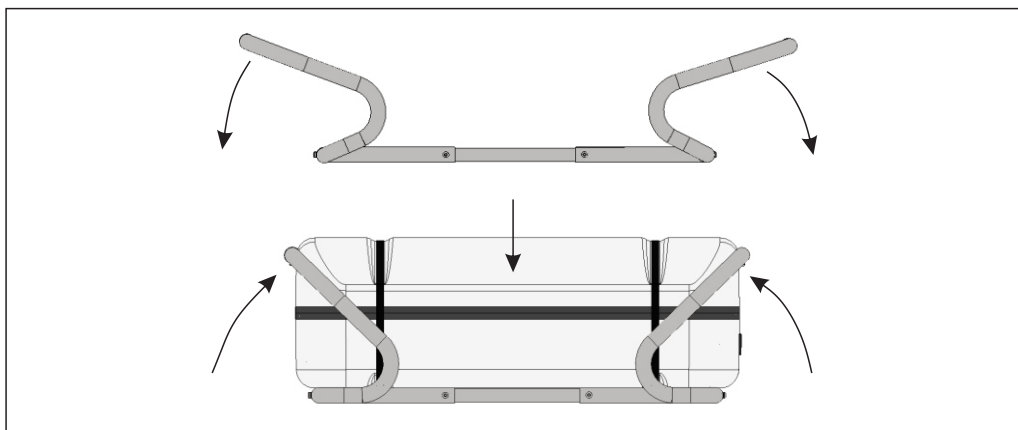

6.0 STRAPPING

6.1 Secure the liferaft in the cradle by pulling the two longest straps over the top of the liferaft. Ensure the straps are fed around the outside of the cradle and are resting on top of the rubber grip, as shown below. (Make sure the arms are fully rotated up to the raft).

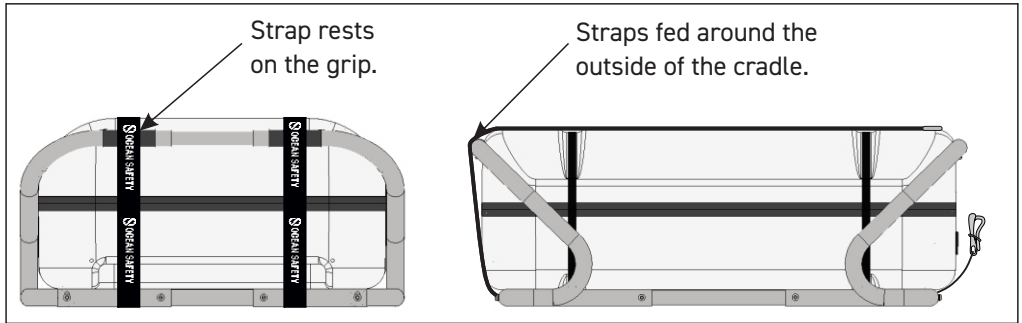

6.2 If fitting a Hammar Hydrostatic Release Unit go to step 6.4 otherwise follow 6.3.

6.3 Attach the bow shackle to the pelican hook. (Skip to step 6.5).

6.4 If using a Hammar Hydrostatic Release Unit, attach the black loop of the Hammar unit to the bow shackle and the pelican hook to the yellow loop. (Note: this is not included in the product and must be bought separately.)

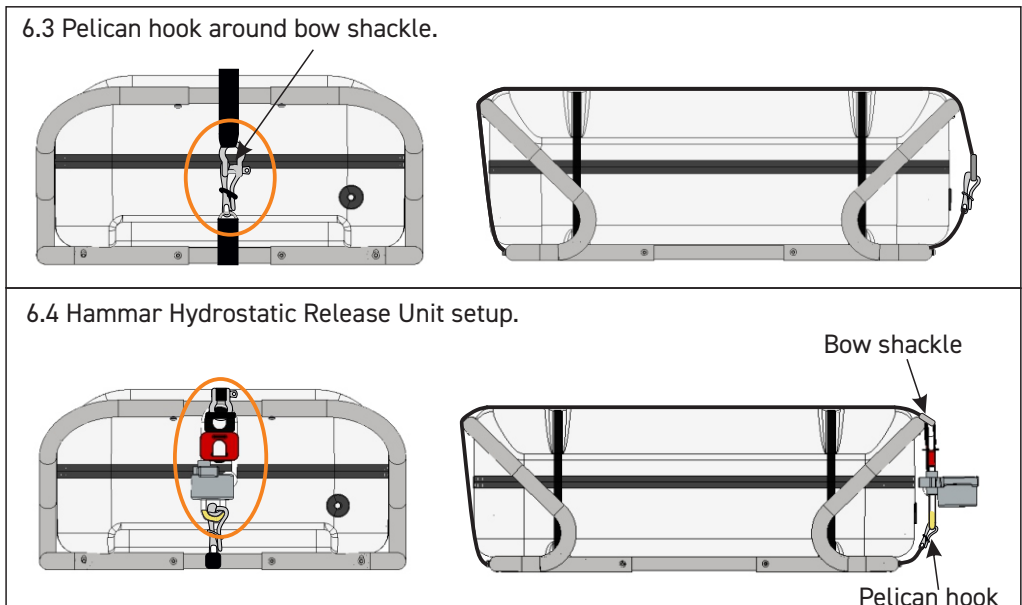

6.0 STRAPPING

6.6 Tighten the straps by pulling the loose end.

6.7 As you tighten the straps, ensure that the load is spread evenly. The strap may need to be manually pulled through the bow shackle then tightened again multiple times. There should be a constant tension over the entire strap.

6.8 Check the strap is still positioned over the grip on the arms and has not moved. Re-position if necessary. Slide the tri glide along to tidy the loose end.

Ensure even tension over the straps and positioned over the grip.

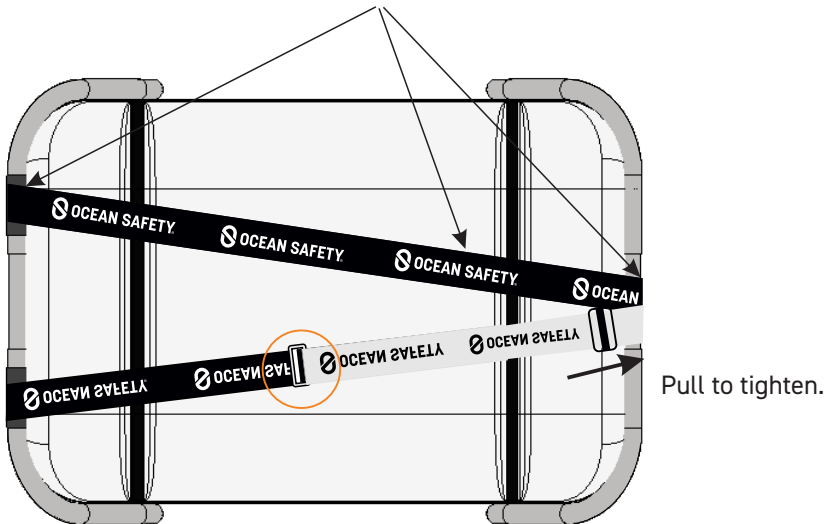

WARNING: MAKE SURE THIS DOES NOT AFFECT THE OPERATION OF THE PELICAN HOOK OR HAMMAR HYDROSTATIC RELEASE UNIT.



WARNING: THE STRAP SHOULD NEVER BE LOOSENEED UNLESS BEING SERVICED.



7.0 MANUALLY RELEASING THE LIFERAFT



NOTE: THE LIFERAFT MUST ONLY BE REMOVED FROM THE CRADLE IN AN EMERGENCY OR TO BE SERVICED



7.1 The raft is manually released by pushing down the ring on the pelican hook. Once complete the liferaft can be lifted out the cradle.

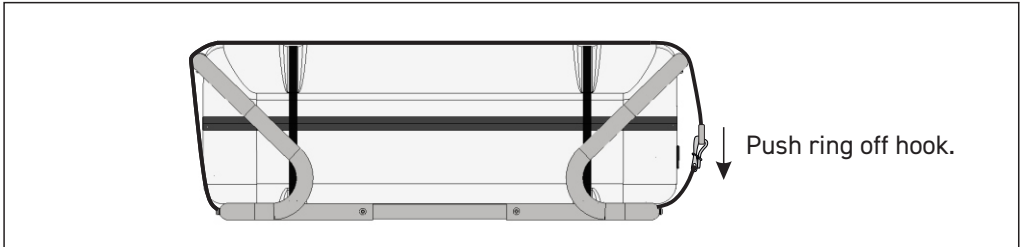

7.2 The side arms can be rotated up and down to lift the raft in and out. Push the arms out to remove the liferaft.

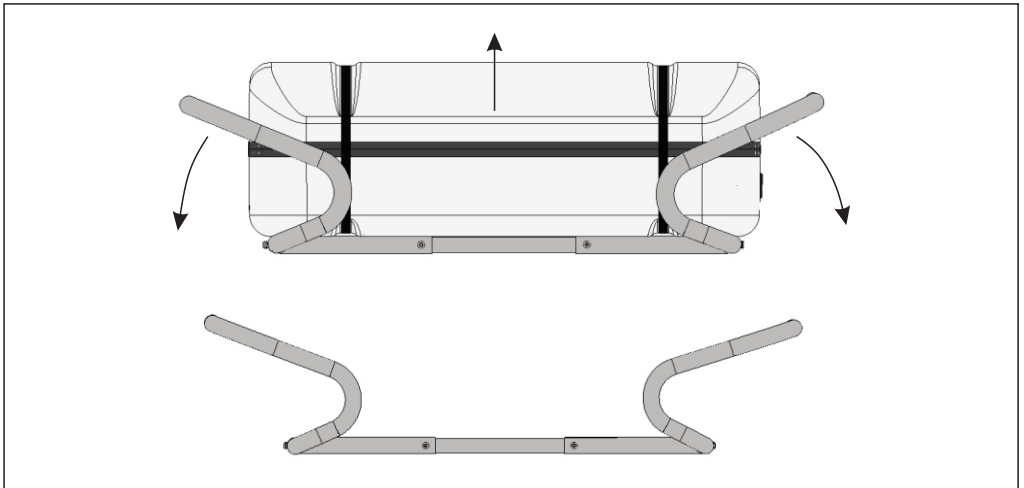

8.0 CARE AND MAINTENANCE



8.1 Before leaving the shore or dock:

1. Check the strapping has not worn, torn and is still under tension
2. Check the liferaft still fits tightly inside the cradle
3. Check the cradle has not moved or fixings have not loosened
4. Check the deck it is fitted to has not weakened
5. If you have any concerns, contact your nearest Ocean Safety service station
6. If any part of the product is damaged or faulty replace immediately

OCEAN SAFETY
Saxon Wharf
Lower York Street
Southampton
Hampshire
SO14 5QF

Tel: +44 (0)2380 720800
Email: info@oceansafety.com
Web: www.oceansafety.com